

RoHS

Reach

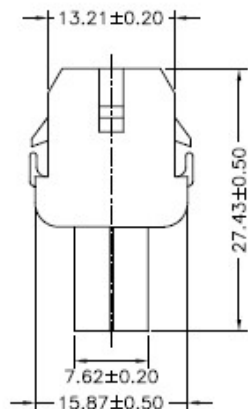
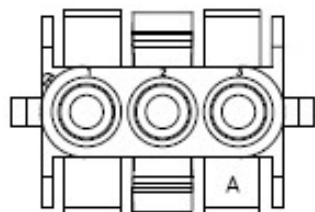
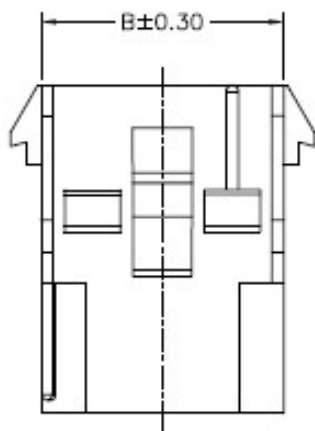
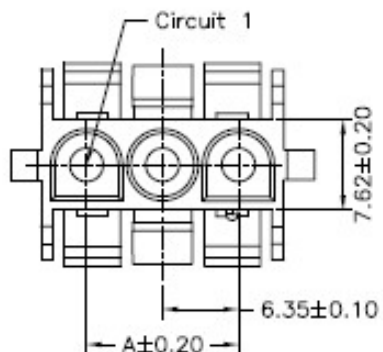

## Ordering Information &amp; Dimension

Circuit NO.	Dimensions	
	A	B
02	6.35	13.97
03	12.70	20.32
04	19.05	26.67
05	25.40	33.02
06	31.75	39.37
08	44.45	52.07

Explanation of PN.

6350J HM XX - X XX

① ② ③ ④ ⑤

- ① Series No.
- ② Connector Type : Male Housing
- ③ Circuits No.
- ④ Insulator Material : 2: Nylon66, UL 94-V2  
3: Nylon66, UL 94-V0  
7: Nylon66, UL 94-V2(No Flame)
- ⑤ Color : NL: Natural(Translucent) -- Nylon66, UL 94-V2  
WH: Natural(White) -- Nylon66, UL 94-V0  
NL: Natural(Beige) -- Nylon66, UL 94-V2(No Flame)

Specification :

Current Rating : 15A AC,DC

Voltage Rating : 600V AC,DC

Temperature Range : -25°C ~ +85°C

Contact Resistance : 3.5mΩ Max.

Insulation Resistance : 1000mΩ Min.

Withstanding Voltage : 5000V AC/minute

Insulator Material : Nylon66, UL 94-V2 or  
Nylon66, UL 94-V0 or  
Nylon66, UL 94-V2 (No Flame)

**DESCRIPTION :**  
6.35mm Pitch, Housing,  
Single row, Male Type,  
Without Mounting Ear

**PART NO. :**  
6350JHMXX-XXX

**GENERAL TOLERANCE**

X.X ± 0.25  
X.XX ± 0.15  
X.XXX ± 0.05

SCALE : Free

