

RoHS

Reach

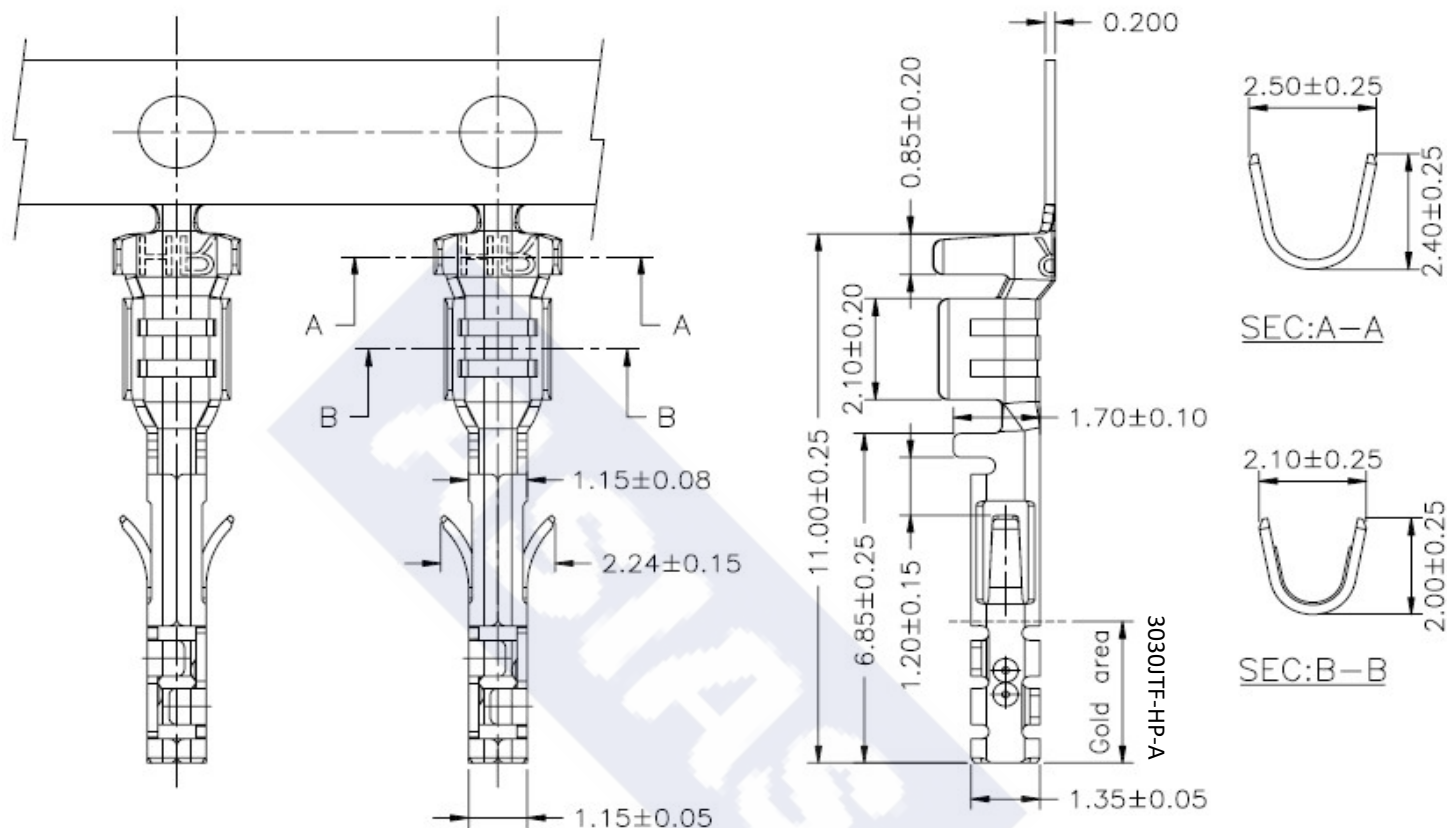

Ordering Information & Specification

Part NO.	Wire Range	Insulation O.D.	Material	Finish	SPQ
3030JTF-TP-A	AWG#20~AWG#24	1.85mm(max)	Phosphor Bronze	Tin-plated	15,000 pcs/reel
3030JTF-HP-A	AWG#20~AWG#24	1.85mm(max)	Phosphor Bronze	Gold-flash	15,000 pcs/reel

** Stamping before plating

DESCRIPTION :
3.00mm Pitch,
Crimp Terminal, Female Type,
A Type

PART NO. :
3030JTF-XX-A

GENERAL TOLERANCE

X.X ± 0.25
 X.XX ± 0.15
 X.XXX ± 0.05

SCALE : Free

