

RoHS

Reach

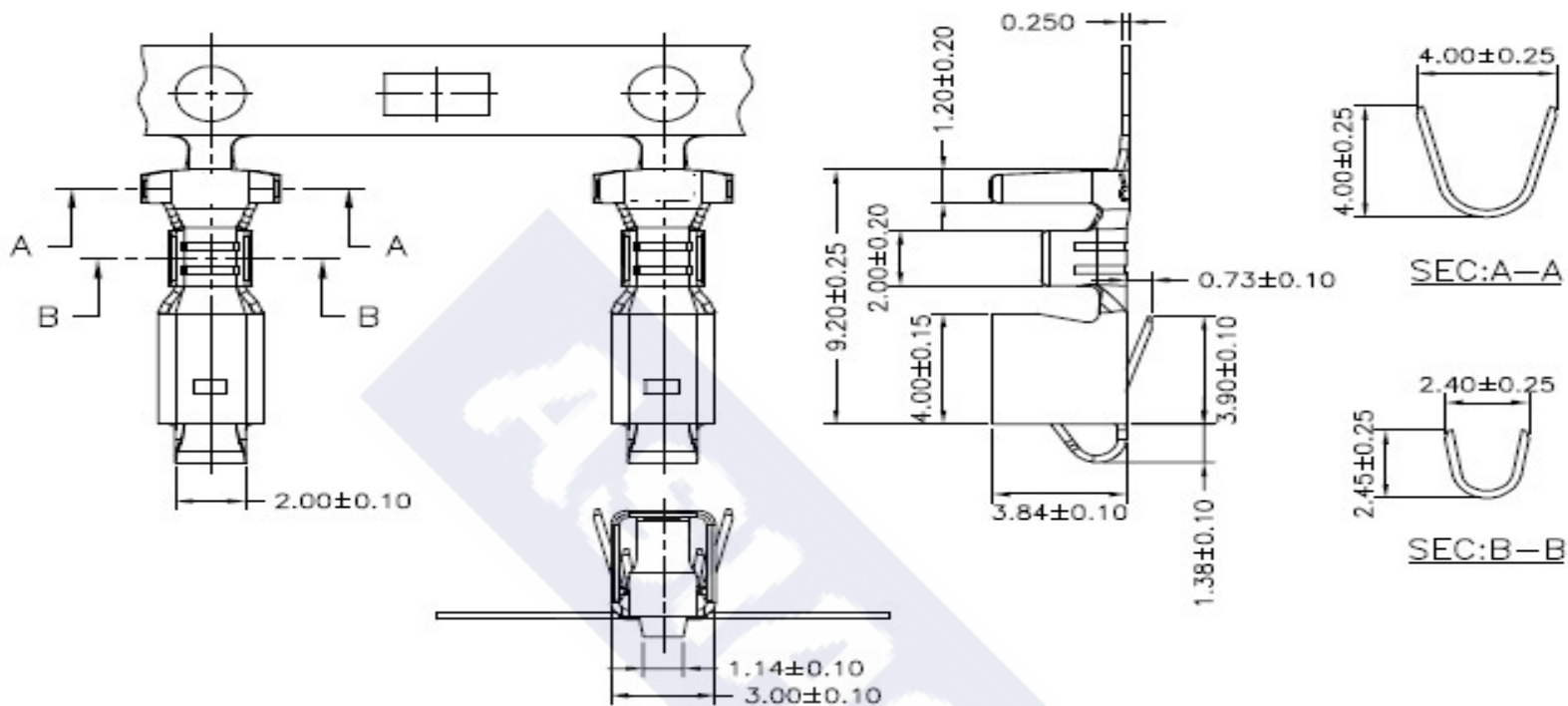

Ordering Information & Specification

Part NO.	Wire Range	Insulation O.D.	Material	Finish	SPQ
3961JT-TB	AWG#18~AWG#22	3.00mm(max)	Brass	Tin-plated	4,000 pcs/reel
3961JT-TP	AWG#18~AWG#22	3.00mm(max)	Phosphor Bronze	Tin-plated	4,000 pcs/reel
3961JT-GP	AWG#18~AWG#22	3.00mm(max)	Phosphor Bronze	Gold-flash	4,000 pcs/reel

** Stamping before plating

DESCRIPTION :
**3.96mm Pitch,
 Crimp Terminal**

PART NO. :
3961JT-XX

GENERAL TOLERANCE

X.X ± 0.25
 X.XX ± 0.15
 X.XXX ± 0.05

SCALE : Free

