

RoHS

Reach

02 ~03

04 ~06

07 ~15

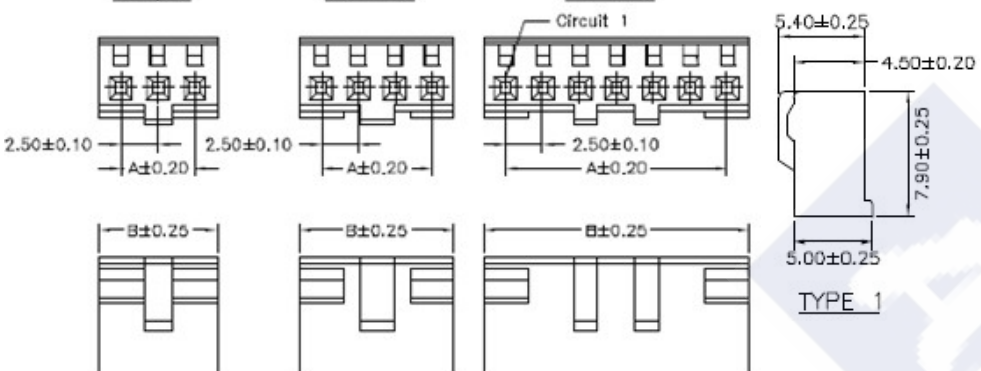

13 ~15

6.00±0.25

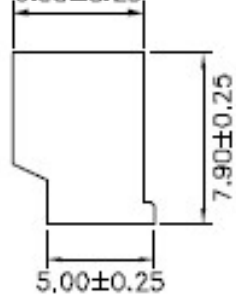

TYPE 2

Ordering Information & Dimension

Circuit NO.	Dimensions	
	A	B
02	2.50	5.50
03	5.00	8.00
04	7.50	10.50
05	10.00	13.00
06	12.50	15.50
07	15.00	18.00
08	17.50	20.50
09	20.00	23.00
10	22.50	25.50
11	25.00	28.00
12	27.50	30.50
13	30.00	33.00
14	32.50	35.50
15	35.00	38.00

Explanation of PN.

2500J H X XX - 3 XX

① ② ③ ④ ⑤ ⑥

- ① Series No.
- ② Connector Type : Housing
- ③ Option Type : 1 : Type 1
2 : Type 2
- ④ Circuits No.
- ⑤ Insulator Material : Nylon66, UL 94-V0
- ⑥ Color : RD : Red(153C)

Specification :

Current Rating : 3A AC,DC

Voltage Rating : 500V AC,DC

Temperature Range : $-25^{\circ}\text{C} \sim +85^{\circ}\text{C}$ Contact Resistance : 20m Ω Max.Insulation Resistance : 100m Ω Min.

Withstanding Voltage : 1500V AC/minute

Insulator Material : Nylon66, UL 94-V0

DESCRIPTION :
2.50mm Pitch,
Housing, Single Row

PART NO. :
2500JHXXX-3RD

GENERAL TOLERANCE

X.X \pm 0.25
X.XX \pm 0.15
X.XXX \pm 0.05

SCALE : Free

