

RoHS

Reach

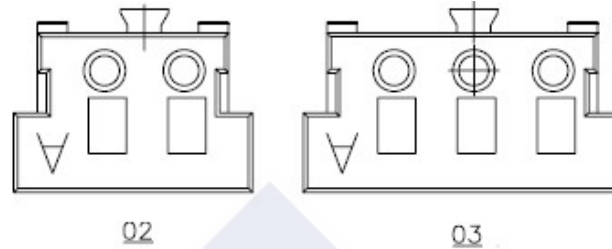
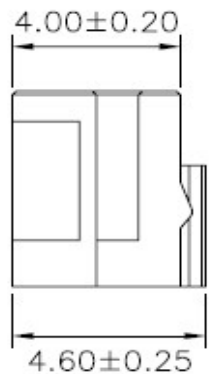
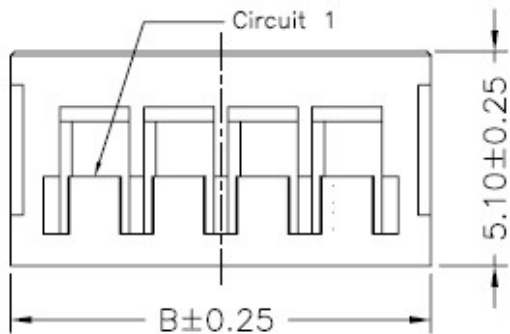
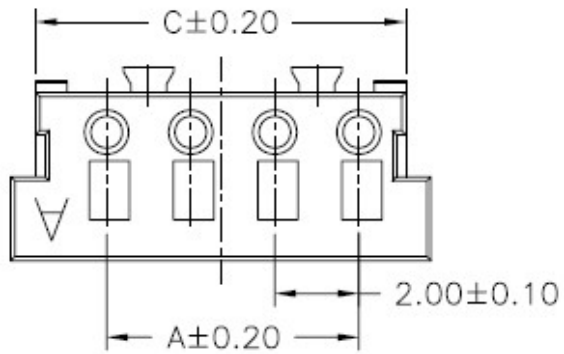

Ordering Information & Dimension

| Circuit No. | Dimensions | | |
|-------------|------------|-------|-------|
| | A | B | C |
| 02 | 2.00 | 6.00 | 4.80 |
| 03 | 4.00 | 8.00 | 6.80 |
| 04 | 6.00 | 10.00 | 8.80 |
| 05 | 8.00 | 12.00 | 10.80 |
| 06 | 10.00 | 14.00 | 12.80 |
| 07 | 12.00 | 16.00 | 14.80 |
| 08 | 14.00 | 18.00 | 16.80 |
| 09 | 16.00 | 20.00 | 18.80 |
| 10 | 18.00 | 22.00 | 20.80 |
| 11 | 20.00 | 24.00 | 22.80 |
| 12 | 22.00 | 26.00 | 24.80 |
| 13 | 24.00 | 28.00 | 26.80 |
| 14 | 26.00 | 30.00 | 28.80 |
| 15 | 28.00 | 32.00 | 30.80 |

Explanation of PN.

2013J H XX - 3 WH

① ② ③ ④ ⑤

- ① Series No.
- ② Connector Type : Housing
- ③ Circuits No.
- ④ Insulator Material : Nylon66, UL 94-V0
- ⑤ Color : WH : White

Specification :

Current Rating : 4A AC,DC

Voltage Rating : 125V AC,DC

Temperature Range : -25°C ~ +85°C

Contact Resistance : 10mΩ Max.

Insulation Resistance : 1000mΩ Min.

Withstanding Voltage : 1000V AC/minute

Insulator Material : Nylon66, UL 94-V0

DESCRIPTION :
2.00mm Pitch,
Housing, Single Row

PART NO. :
2013JHXX-3WH

GENERAL TOLERANCE

X.X ± 0.25
X.XX ± 0.15
X.XXX ± 0.05

SCALE : Free

