

RoHS

Reach

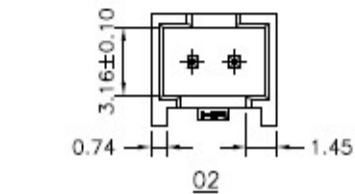
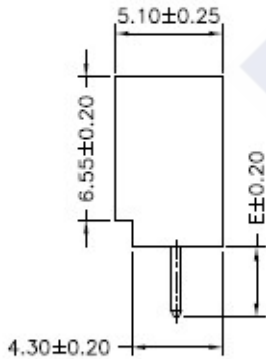
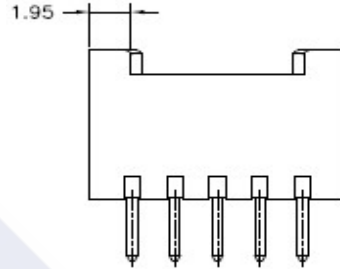
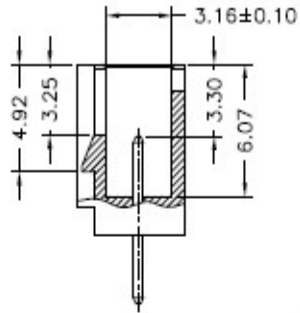
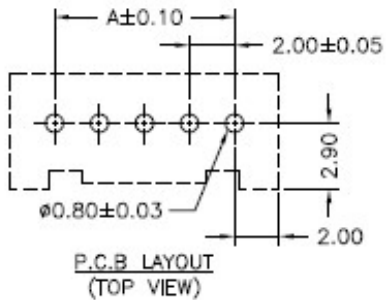
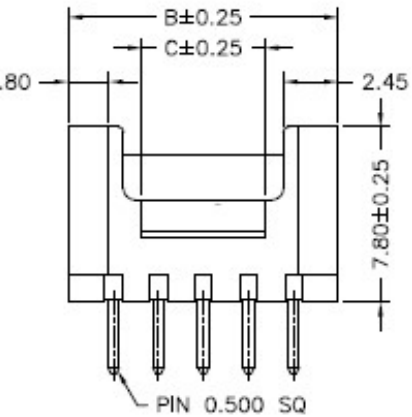
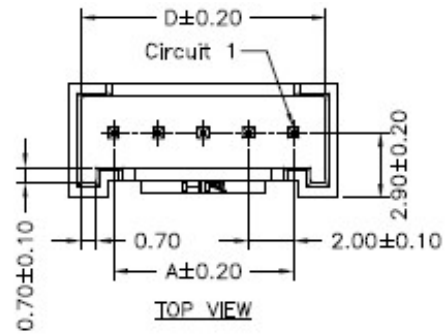

Ordering Information & Dimension

Circuit No.	Dimensions			
	A	B	C	D
02	2.00	6.00	1.50	4.90
03	4.00	8.00	1.46	6.90
04	6.00	10.00	3.46	8.90
05	8.00	12.00	5.46	10.90
06	10.00	14.00	7.46	12.90
07	12.00	16.00	9.46	14.90
08	14.00	18.00	11.46	16.90
09	16.00	20.00	13.46	18.90
10	18.00	22.00	15.46	20.90
11	20.00	24.00	17.46	22.90
12	22.00	26.00	19.46	24.90
13	24.00	28.00	21.46	26.90
14	26.00	30.00	23.46	28.90
15	28.00	32.00	25.46	30.90
16	30.00	34.00	27.46	32.90

Explanation of PN.

2006J V X XX - 1 XX 2

① ② ③ ④ ⑤ ⑥ ⑦

- ① Series No.
- ② Connector Type : Straight Angle
- ③ Pin Length : 1 : E=3.20mm
2 : E=2.10mm
- ④ Circuits No.
- ⑤ Insulator Material : 1 : Nylon46, UL 94-V0
- ⑥ Color : NL : Natural(Beige)
BK : Black
- ⑦ Contact Plating : 2 : Gold-flash

Specification :

- Current Rating : 3A AC,DC
- Voltage Rating : 250V AC,DC
- Temperature Range : -25°C ~ +85°C
- Contact Resistance : 30mΩ Max.
- Insulation Resistance : 1000mΩ Min.
- Withstanding Voltage : 1000V AC/minute
- Pin Material : Brass
- Insulator Material : Nylon46, UL 94-V0

	DESCRIPTION : 2.00mm Pitch, Receptacle, Single Row, DIP, Straight Angle	GENERAL TOLERANCE	
	PART NO. : 2006JVXXX-1XX2	X.X ± 0.25 X.XX ± 0.15 X.XXX ± 0.05	SCALE : Free