

RoHS

Reach

## Ordering Information &amp; Dimension

Circuit NO.	Dimensions		Circuit NO.	Dimensions	
	A	C		A	C
04	2.00	5.90	28	26.00	29.90
06	4.00	7.90	30	28.00	31.90
08	6.00	9.90	32	30.00	33.90
10	8.00	11.90	34	32.00	35.90
12	10.00	13.90	36	34.00	37.90
14	12.00	15.90	38	36.00	39.90
16	14.00	17.90	40	38.00	41.90
18	16.00	19.90	42	40.00	43.90
20	18.00	21.90	44	42.00	45.90
22	20.00	23.90	46	44.00	47.90
24	22.00	25.90	48	46.00	49.90
26	24.00	27.90			

Explanation of PN.

2004J H D XX - 3 WH

① ② ③ ④ ⑤ ⑥

- ① Series No.
- ② Connector Type : Housing
- ③ Row Type : Dual row
- ④ Circuits No.
- ⑤ Insulator Material : 3 : Nylon66, UL 94-V0
- ⑥ Color : WH : White

Specification :

Current Rating : 3A AC,DC

Voltage Rating : 250V AC,DC

Temperature Range : -25°C ~ +85°C

Contact Resistance : 10mΩ Max.

Insulation Resistance : 1000mΩ Min.

Withstanding Voltage : 800V AC/minute

Insulator Material : Nylon66, UL 94-V0

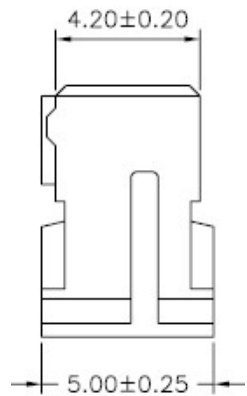
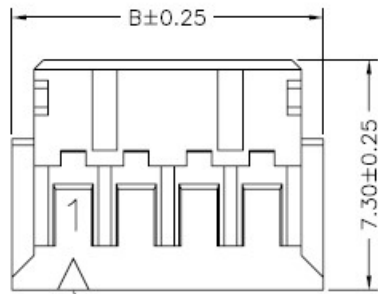
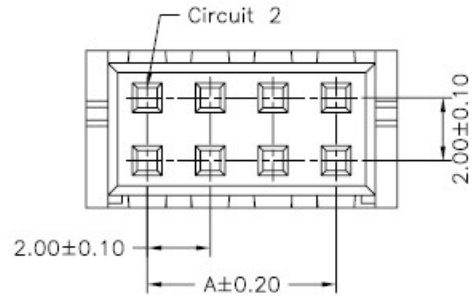

	<b>DESCRIPTION :</b> 2.00mm Pitch, Housing, Dual row, Without Mounting Ear	<b>GENERAL TOLERANCE</b>	
	<b>PART NO. :</b> 2004JHDXX-3WH	X.X ± 0.25 X.XX ± 0.15 X.XXX ± 0.05	SCALE : Free 